

FLIPORB

USER MANUAL

Product Lineup

BLUE RUSH

[TFO-001]

Bounding orbs await within rows of wavy ribs!



ORANGE CRASH

[TFO-002]

Bounding orbs await within countless enveloping nubs!

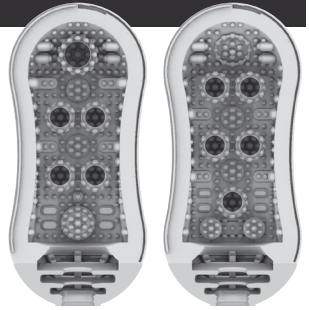

STRONG EDITION

BLUE RUSH

[TFO-001H]

Undulating waves combine with a firmer material and stronger orbs for intense sensations!



STRONG EDITION

ORANGE CRASH

[TFO-002H]

Dynamic edges combine with a firmer material and stronger orbs for intense sensations!



Product Content

● FLIP ORB Product



- Sample Lotion × 2 [Each Single Use]
- ※ We recommend the TENGA HOLE LOTION Series (sold separately) for further uses of the FLIP ORB.

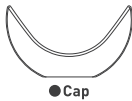

● Cap

How to Use



① Remove Cap by pulling it away from the FLIP ORB.

② Squeeze the slide rails to open.

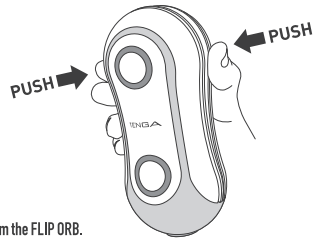

How to Use

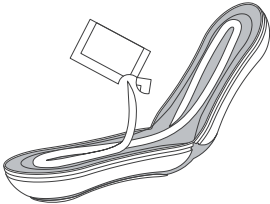

③ Fully lubricate the inside of the item. Once lubricated, close the item and lubricate the insertion point. Over-lubrication may cause leakage of lotion during use.

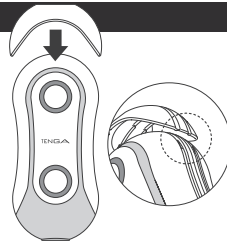

④ Replace cap on the opposite side of the insertion point until it clicks into place. Ensure it is placed as shown in the image with the rails inside the Cap.

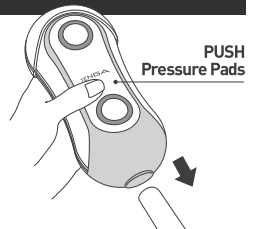

⑤ Enjoy, changing internal pressure using the Pressure Pads.

How to Clean

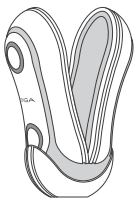

① Wash with cold or tepid water. You may use a neutral soap. Ensure to rinse thoroughly.

② Shake off excess water and pat dry with a soft cloth.

③ Using the Cap as shown in the image, allow item to fully air dry.

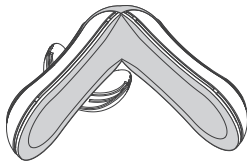

How to Store

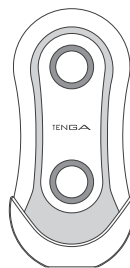

- Once the item is fully dry, replace Cap as shown in image and store.

- Store in a cool, dry, dark place away from direct sunlight and dust.

TENGA HOLE LOTION Series (Sold Separately)

The FLIP ORB is best used with TENGA HOLE LOTION Series.

[MILD]	[WILD]	[REAL]	[SOLID]
----------	----------	----------	-----------

Tester lotion is a single-use amount of HOLE LOTION [REAL] x2.

Warning

Do not use on damaged, irritated or otherwise abnormal skin. If you experience any discomfort or irritation, stop use immediately and consult a medical professional. After use, ensure no lotion or other fluids remain on the item by washing thoroughly with tepid water and mild soap, and ensure product is completely dry before storing. Do not wash with alcoholic cleaners, or corrosive substances such as benzine or paint thinner. This may damage the item. Silicone-based / oil-based lubricants / other oils such as massage oil or baby oil may cause damage to the product material. Lotion may leak during use. Please ensure you use the item on a surface where this can occur. Do not boil. Store at cool to room temperature. Keep away from the reach of children. Do not place near nose or mouth to avoid suffocation risk. Do not use in any way other than stated on this User Manual. Do not share this product with others to prevent risk of STIs. Do not use this product if it is damaged in any way. This is a novelty item. TENGA Co., Ltd. can not be held liable if used in any way other than that stated in this User Manual. Use at own risk.

- Materials: ABS / PC / Elastomer

- Dimensions (mm) / W86 × D71 × H178

- Weight: BLUE RUSH - Approx: 420g
ORANGE CRASH - Approx: 400g

BLUE RUSH (STRONG) - Approx: 410g

ORANGE CRASH (STRONG) - Approx: 400g

DESIGN PATENT PENDING MADE IN JAPAN
Manufactured by TENGA Co., Ltd. 1-7-1 Mita, Minato, Tokyo 108-0073, JAPAN.
TENGA Europe GmbH - Immermannstr. 15, 40210 Düsseldorf, GERMANY
For more information, please visit: tenga-global.com